

F18 Exhaust trunk.

Print the attached templates from the last 2 pages

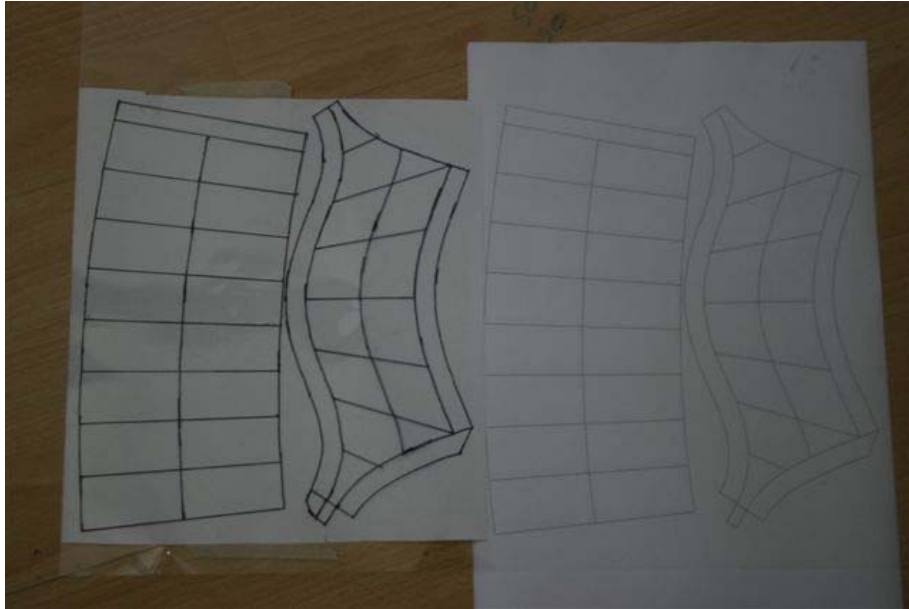

Place the print-outs under the supplied plastic sheets. Tape them so the print outs stay in place. Then trace the template with a (CD-DVD) markers. Also trace the station-lines as they should match up when you tape the pieces together. Print out on A4 size paper 100%.

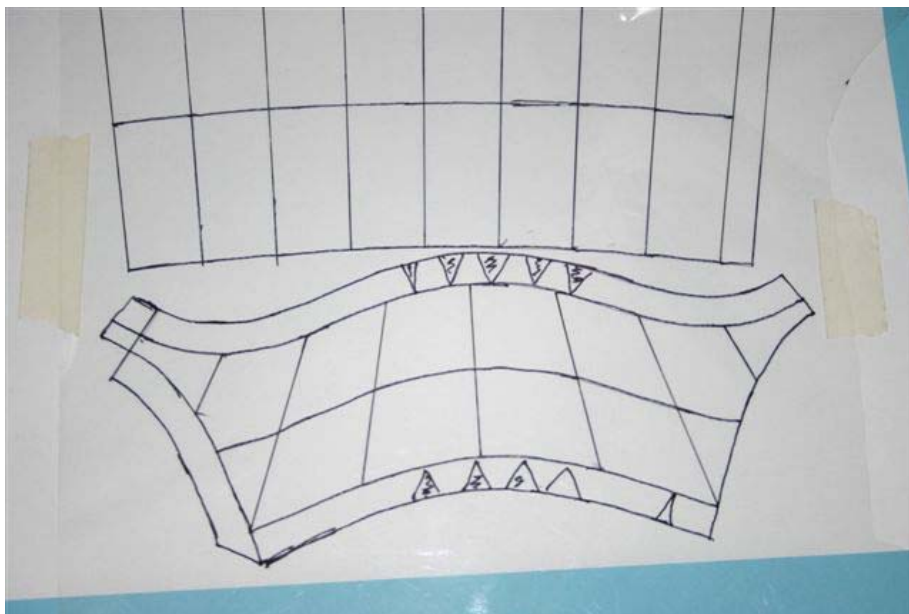

When you have cut out the pieces 6 total cut some 3 angular pieces from the overlapping edges. Otherwise the parts won't fit.

On this page You see 1 halve of the exhaust trunk  
Notice the station-lines.

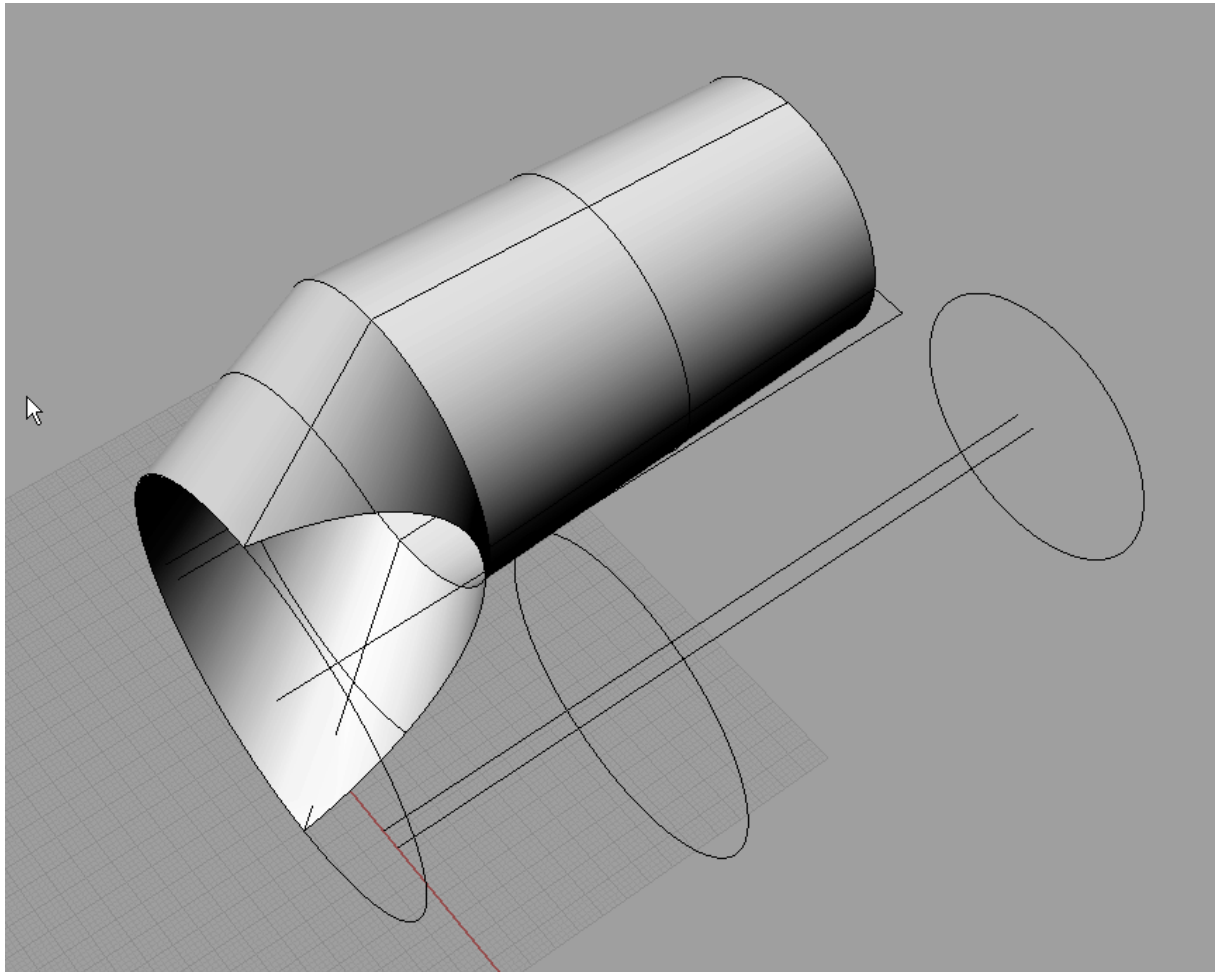

On this page you see the 2 halves put together.

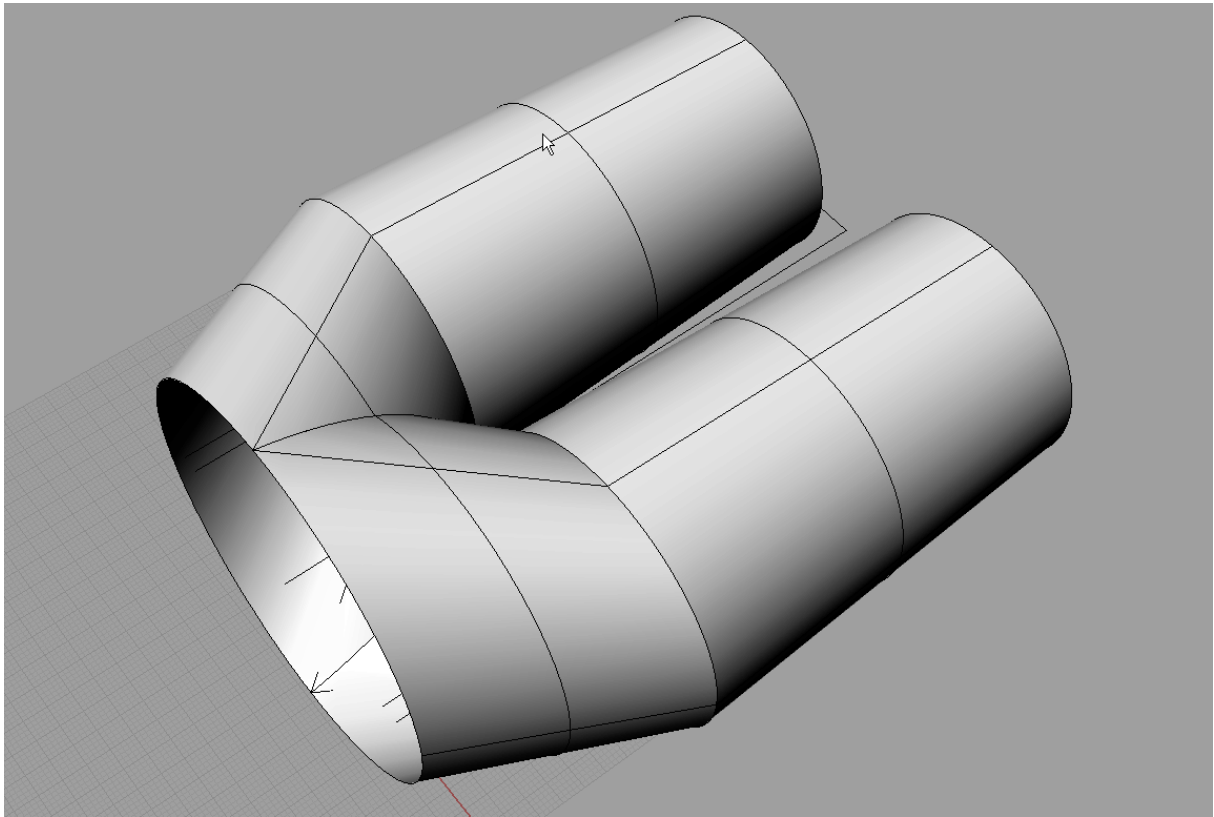

On this page you see the finished exhaust- trunk.

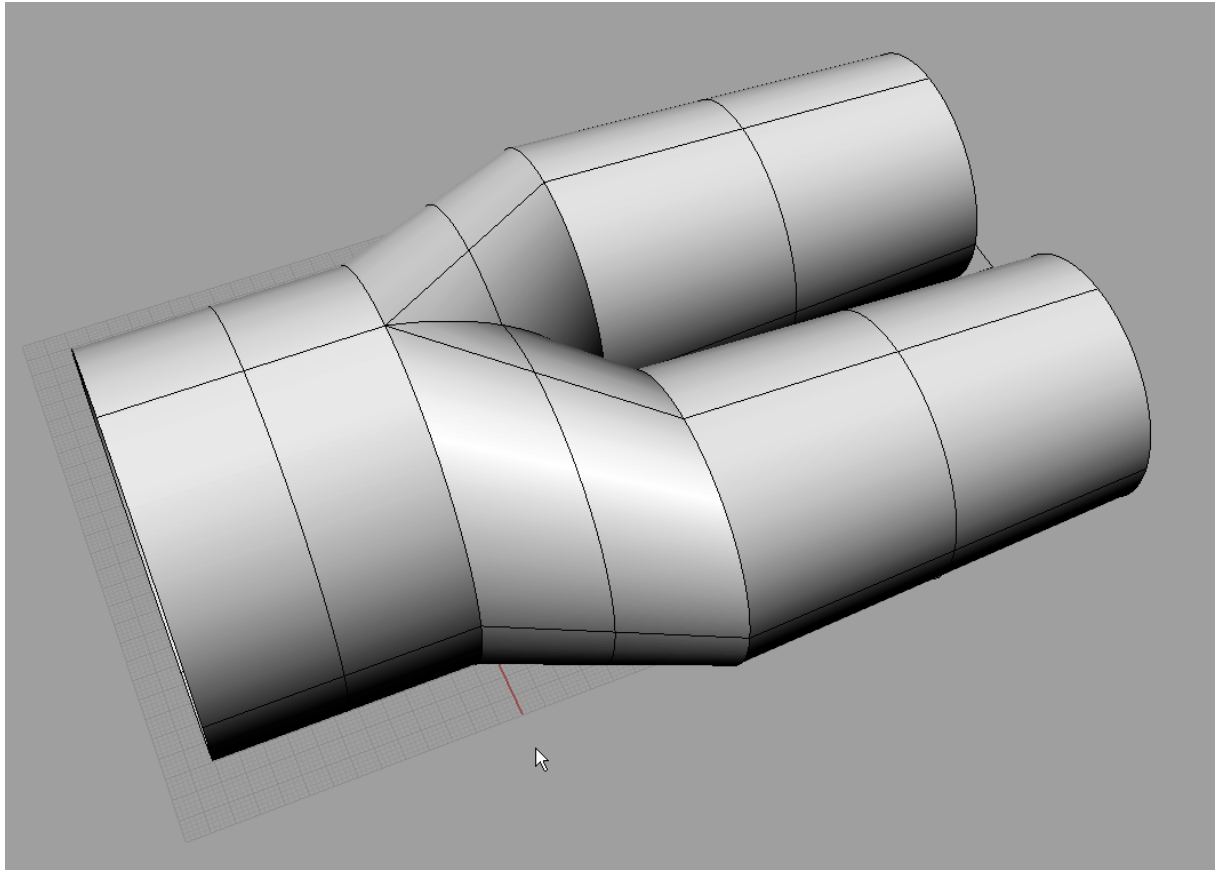

Look carefully at this picture the tabs on the 93mm tube front are on the outside while the tabs in the 2 exhaust-tubes are on the inside

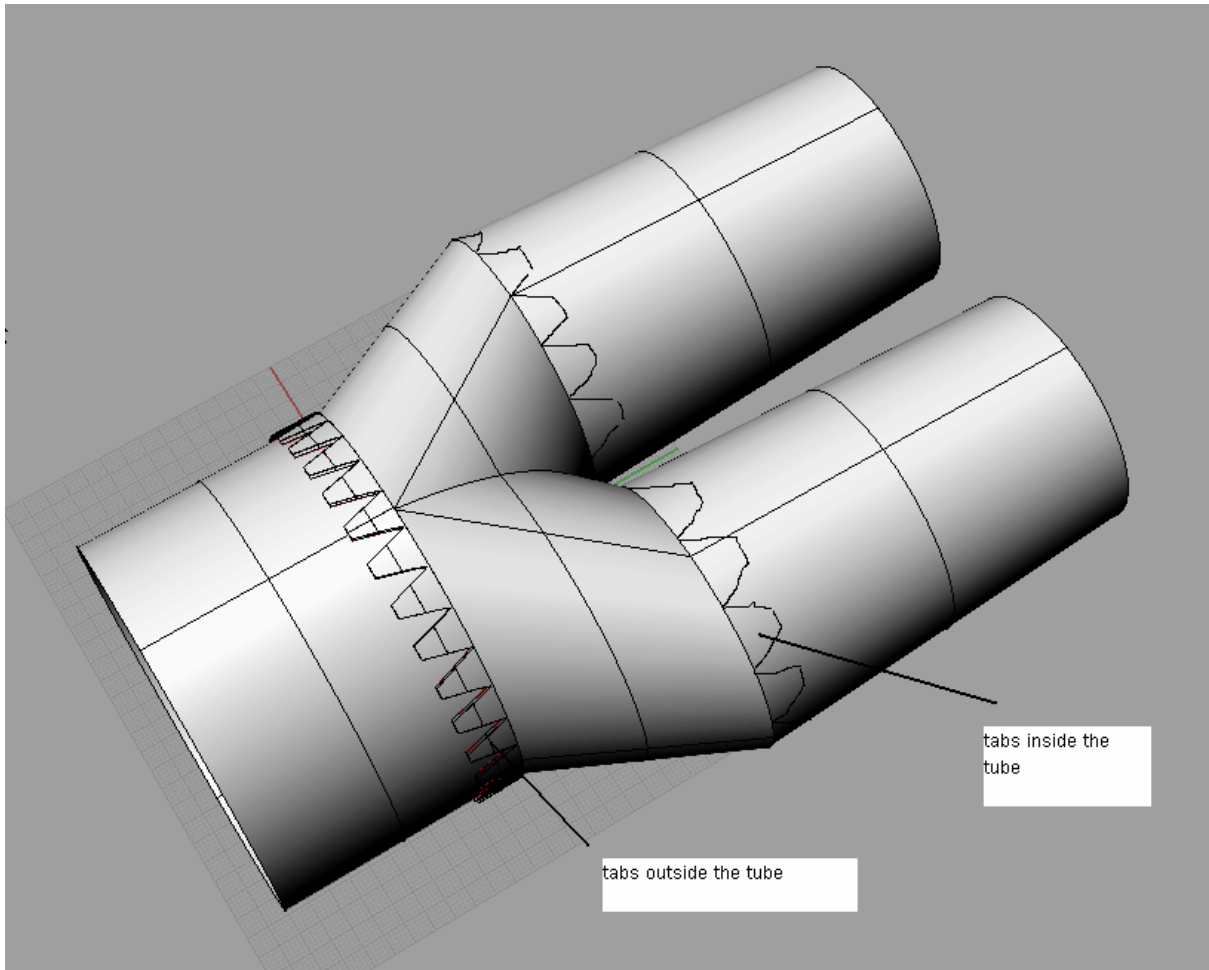

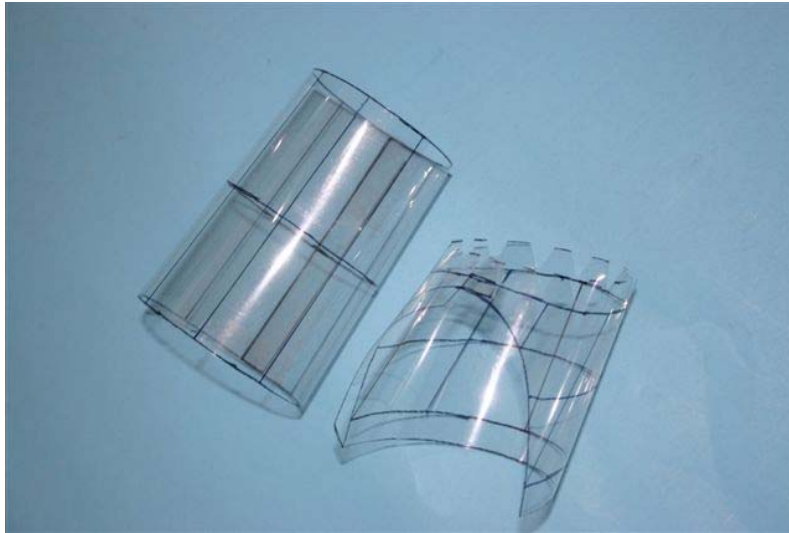

After you have cut out the plastic pieces from the plastic sheet. Tape the pieces together. Like on the left picture. Notice the edge of right piece. Small triangular pieces are cut out.

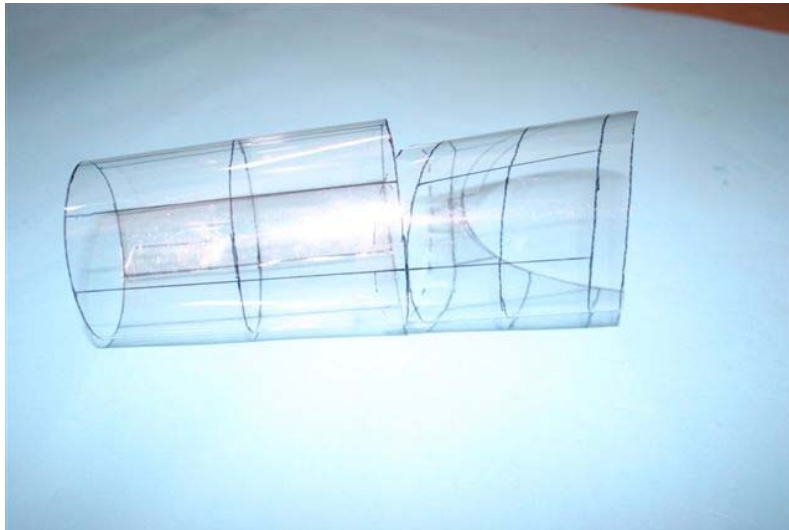

Now join the 2 pieces match up the station-lines on both pieces. Use a small piece of tape to tape them together. The edge of the right side piece must fall inside the left tube. Now tape the two parts together. Make sure all station-lines match.



One side is now ready, So now you can start on the other side.



Here you can see the 2 halves joint together. All pieces are taped together.

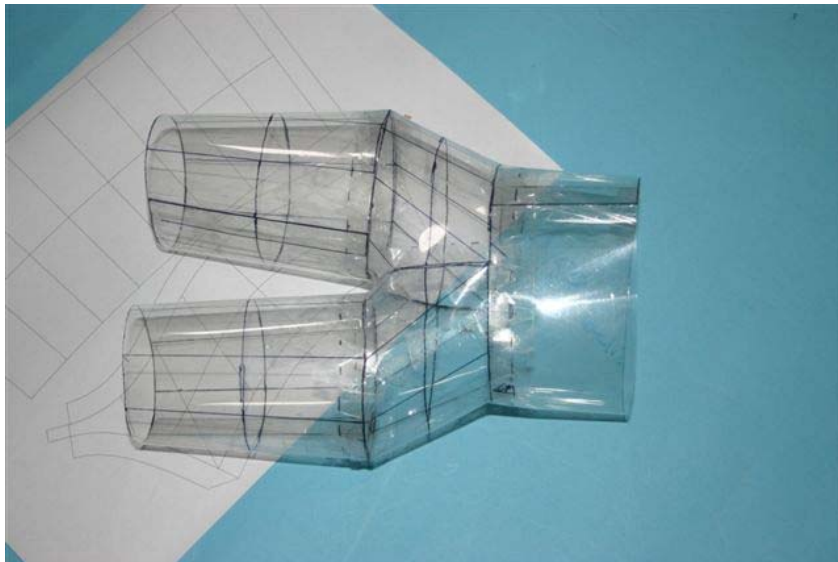

Now the front tube is added.



Trunk attached to the fan- unit. Make 10mm slots in the mounting flanges of the fan-unit so that the exhaust can slip over the fan-unit shroud. Install your motor in the fan-unit. Use the installation manual from the fan-unit. Shown here is our 9305 fan-unit.

## HIGH-END TECHNOLOGY RC



When you install the fan-unit with exhaust trunk in the fuselage, you must tape the trunk first to the shroud. Because the plastic film is flexible you can fold it a little bit to get it inside the back part of the fuselage.



Here's the trunk and fan-unit installed in the fuselage. Hardly any wrinkles. Notice the station-lines on the plastic film.



The exhaust must have an inner diameter of approximately 59 mm so you must cut off 18-19 mm from the 2 exhausts.

